



336S Cabinets

Cabinets for Traffic Management

The Safetran® 336S Series of traffic control cabinets are built to the exacting standards and specifications of NYDOT, Caltrans, FHWA, and TEES. Each 336S cabinet features a 19-inch EIA rack that provides ultimate ease and flexibility of traffic control component configuration.

The modular design of Econolite's Safetran 336S cabinet provides control of up to eight vehicle and four pedestrian phase. The 336S Series of cabinets also meet the stringent weatherproof requirements for State of California TEES enclosures and can be delivered UL-approved.

Econolite's Safetran 336S Series of traffic cabinets securely houses the signal controller and other vital intersection electronic equipment that manages efficient intersection operations and traffic flow. The strict adherence to industry standards and specifications ensures the highest levels of safety for all roadway users.

Equipment shown in cabinet is for demonstration purposes only. See details on back for what is included.

Key Features

- Meet all FHWA requirements
- Two doors (front and rear)
- Mounted one base, side of pole, or top of post
- Three-point locking system
- Suited for intersection and controllers and accessories

336S Cabinets: Description

The use of standard sub-assemblies, as pre-defined by Caltrans, assures interchangeability between manufacturers. All sub-assemblies are mounted in a removable 19" EIA rack for ease of maintenance and are fully interchangeable with the Model 332, 336 and 333 cabinets. The 336S cabinet is taller than the standard 336 cabinet and has space available for optional equipment such as 2 shelves for 2 controllers, or an Auxiliary Output file and a drawer/shelf assembly. Constructed of heavy 0.125 inch aluminum, the 336S provides a durable, weatherproof enclosure. The 336S can be base mounted using an 8" high "M" base adapter or can be mounted on the side-of-pole or top-of-post positions.

Specifications	336S Cabinets
Dimensions	46 in H X 24 in W X 20 in D
Finish	Anodized, bare, painted, or anti-graffiti
Material	Aluminum 0.125 in.
Ship Weight	280 lbs.
UL Lable	Cabinet Housing UL 3R listed, UL File #E256326 (label optional)

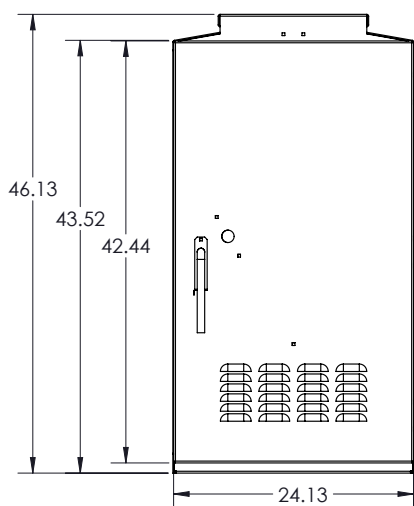

Front View

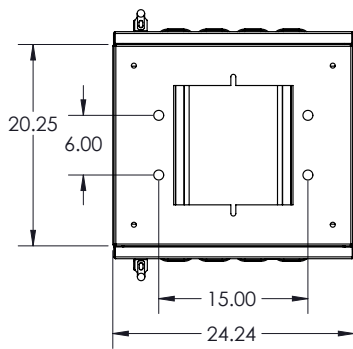

Top View

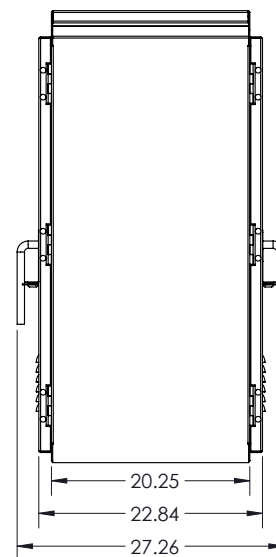

Side View